

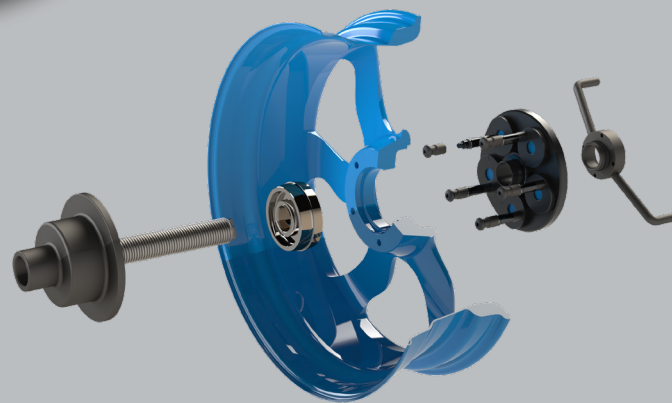

## Wheel balancers



**High-precision flange for optimal wheel clamping**



**50% of a good balancing depends on the wheel clamping and centring system. Why risk it?**

## MAIN FEATURES

- **Excellent** balancing results!
- **Uniform axle load** distribution, like wheel bolts on the vehicle
- **Quick and easy set-up**
- **Indestructible** and **lightweight (only 1.5 kg)**
- **Secure clamping and balancing.** No damage to alloy wheel surfaces or cracks in plastic-coated wheels
- **Pin heads** that correctly fit steel and alloy rims, **interchangeable** by means of a quick-release system
- **UNIVERSAL.** Applicable to any Size  $\varnothing$  40 mm. wheel balancer.

**Competent and fast service will inspire confidence, ensuring greater customer loyalty.**

## PRODUCT OVERVIEW



	$\varnothing$ 28
	$\varnothing$ 22,5
	$\varnothing$ 22,5
	$\varnothing$ 19

### 8-21100294 - FPF FASTPLATE 5

for 5-hole rims. Clamping range 95,25 - 180 mm



	$\varnothing$ 28
	$\varnothing$ 22,5
	$\varnothing$ 22,5
	$\varnothing$ 19

### 8-21100295 - FPF FASTPLATE 3-4-6-8

for 3- 4- 6- 8-hole rims. Clamping range 95,25 - 180 mm



	$\varnothing$ 28
	$\varnothing$ 22,5
	$\varnothing$ 22,5
	$\varnothing$ 19

### 8-21100296 - FPF FASTPLATE KIT

for 3- 4- 5- 6- 8-hole rims. Clamping range 95,25 - 180 mm



### 8-21100297 - FPF-C SLEEVE HANDLE

Sleeve for automatic clamping wheel balancers. It screws directly onto the FASTPLATE to make work easier and faster